

() 안의 치수는 다소 변경 될 수 있음.

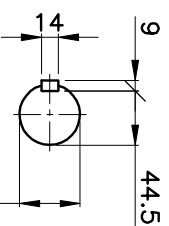

TOLERANCES UNLESS OTHERWISE SPECIFIED		ROUGHNESS		EXTERNAL FORM		SIZE		MATERIAL		QTY		WEIGHT		REMARKS	
DIMENSION	TOL.	SYMBOLS	RA	NO.	DESCRIPTIONS	DRAWN	DESIGNED	CHECKED	APPROVED	DATE	DATE	DATE	DATE	DATE	DATE
Ø50mm	±0.025		0.2												
Ø50mm	±0.009		0.01												
16"	±0.2	▽▽▽	0.8												
18"	±0.3	▽▽▽	0.8												
20"	±0.4	▽▽▽	0.8												
25"	±0.5	▽▽▽	0.8												
30"	±0.6	▽▽▽	0.8												
40"	±1.0	▽▽▽	0.8												
50"	±1.5	▽▽▽	0.8												
60"	±1.5	▽▽▽	0.8												
70"	±1.5	▽▽▽	0.8												
80"	±1.5	▽▽▽	0.8												
90"	±1.5	▽▽▽	0.8												
100"	±1.5	▽▽▽	0.8												
110"	±1.5	▽▽▽	0.8												
120"	±1.5	▽▽▽	0.8												
130"	±1.5	▽▽▽	0.8												
140"	±1.5	▽▽▽	0.8												
150"	±1.5	▽▽▽	0.8												
160"	±1.5	▽▽▽	0.8												
170"	±1.5	▽▽▽	0.8												
180"	±1.5	▽▽▽	0.8												
190"	±1.5	▽▽▽	0.8												
200"	±1.5	▽▽▽	0.8												
210"	±1.5	▽▽▽	0.8												
220"	±1.5	▽▽▽	0.8												
230"	±1.5	▽▽▽	0.8												
240"	±1.5	▽▽▽	0.8												
250"	±1.5	▽▽▽	0.8												
260"	±1.5	▽▽▽	0.8												
270"	±1.5	▽▽▽	0.8												
280"	±1.5	▽▽▽	0.8												
290"	±1.5	▽▽▽	0.8												
300"	±1.5	▽▽▽	0.8												
310"	±1.5	▽▽▽	0.8												
320"	±1.5	▽▽▽	0.8												
330"	±1.5	▽▽▽	0.8												
340"	±1.5	▽▽▽	0.8												
350"	±1.5	▽▽▽	0.8												
360"	±1.5	▽▽▽	0.8												
370"	±1.5	▽▽▽	0.8												
380"	±1.5	▽▽▽	0.8												
390"	±1.5	▽▽▽	0.8												
400"	±1.5	▽▽▽	0.8												
410"	±1.5	▽▽▽	0.8												
420"	±1.5	▽▽▽	0.8												
430"	±1.5	▽▽▽	0.8												
440"	±1.5	▽▽▽	0.8												
450"	±1.5	▽▽▽	0.8												
460"	±1.5	▽▽▽	0.8												
470"	±1.5	▽▽▽	0.8												
480"	±1.5	▽▽▽	0.8												
490"	±1.5	▽▽▽	0.8												
500"	±1.5	▽▽▽	0.8												
510"	±1.5	▽▽▽	0.8												
520"	±1.5	▽▽▽	0.8												
530"	±1.5	▽▽▽	0.8												
540"	±1.5	▽▽▽	0.8												
550"	±1.5	▽▽▽	0.8												
560"	±1.5	▽▽▽	0.8												
570"	±1.5	▽▽▽	0.8												
580"	±1.5	▽▽▽	0.8												
590"	±1.5	▽▽▽	0.8												
600"	±1.5	▽▽▽	0.8												
610"	±1.5	▽▽▽	0.8												
620"	±1.5	▽▽▽	0.8												
630"	±1.5	▽▽▽	0.8												
640"	±1.5	▽▽▽	0.8												
650"	±1.5	▽▽▽	0.8												
660"	±1.5	▽▽▽	0.8												
670"	±1.5	▽▽▽	0.8												
680"	±1.5	▽▽▽	0.8												
690"	±1.5	▽▽▽	0.8												
700"	±1.5	▽▽▽	0.8												
710"	±1.5	▽▽▽	0.8												
720"	±1.5	▽▽▽	0.8												
730"	±1.5	▽▽▽	0.8												
740"	±1.5	▽▽▽	0.8												
750"	±1.5	▽▽▽	0.8												
760"	±1.5	▽▽▽	0.8												
770"	±1.5	▽▽▽	0.8												
780"	±1.5	▽▽▽	0.8												
790"	±1.5	▽▽▽	0.8												
800"	±1.5	▽▽▽	0.8												
810"	±1.5	▽▽▽	0.8												
820"	±1.5	▽▽▽	0.8												
830"	±1.5	▽▽▽	0.8												
840"	±1.5	▽▽▽	0.8												
850"	±1.5	▽▽▽	0.8												
860"	±1.5	▽▽▽	0.8												
870"	±1.5	▽▽▽	0.8												
880"	±1.5	▽▽▽	0.8												
890"	±1.5	▽▽▽	0.8												
900"	±1.5	▽▽▽	0.8												
910"	±1.5	▽▽▽	0.8												
920"	±1.5	▽▽▽	0.8												
930"	±1.5	▽▽▽	0.8												
940"	±1.5	▽▽▽	0.8												
950"	±1.5	▽▽▽	0.8												
960"	±1.5	▽▽▽	0.8												
970"	±1.5	▽▽▽	0.8												
980"	±1.5	▽▽▽	0.8												
990"	±1.5	▽▽▽	0.8												
1000"	±1.5	▽▽▽	0.8												

JEIL ENGINEERING & INDUSTRIAL CO., LTD.